

The background image shows the interior of a museum. In the foreground, there are several rows of dark wooden folding chairs arranged in a lecture hall or classroom setting. To the left, a large, thick wooden pillar stands prominently. In the middle ground, a large, circular, light-colored object, possibly a book cover or a piece of equipment, is visible. The background features large windows with a view of the outdoors, and a whiteboard is mounted on the wall to the right. A single pendant light hangs from the ceiling.

*AMERICAN
BOOKBINDERS
MUSEUM*

meeting | reception | forum | dinner party

AMERICAN BOOKBINDERS MUSEUM

This venue is conveniently located in the heart of San Francisco's SOMA/Yerba Buena district. The museum's urban-contemporary space accommodates corporate and social events, receptions and meetings for up to 112 guests.

FEATURES

- Modern-industrial building with natural light and high ceilings
- A single level of versatile event space that can be divided for two separate experiences
- Walking distance to Moscone Convention Center
- Easy transit access via Muni and BART, with parking garages nearby
- Access to historical bookbinding exhibits
- Complimentary Wi-Fi
- On-site catering preparation space
- On-site event support



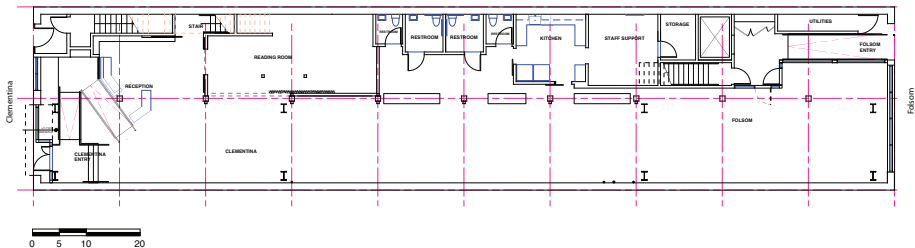

LOCATION

355 Clementina Street
San Francisco

CAPACITY

112 standing
75 theater style
2,625 sq ft

RENTAL INFORMATION

Tansy Grefsheim | 415.530.6615
tansy@bookbindersmuseum.org
www.bookbindersmuseum.org